

# WIRE Holder / Mount

Hankook Fastener

- ◆ MATERIAL: NYLON 66(UL)
- ◆ FLAME CLASS : 94V-2
- ◆ COLOR: NATURAL
- ◆ UNIT: mm

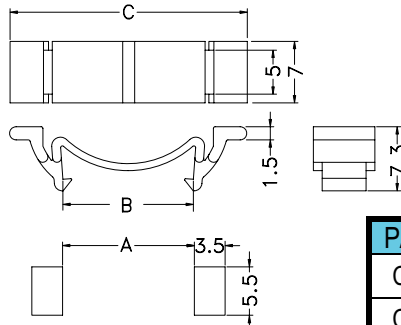

PART NO	A	B	C	PACKAGE
CCMB-15	15.0	17.85	27.0	1000
CCMB-30	30.0	32.18	42.0	

MOUNTING HOLES

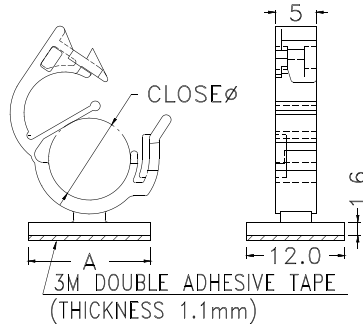

PART NO	A	CLOSE	PACKAGE
CHO-7.6	15.0	7.6	500
CHO-10	19.0	10.0	
CHO-12	20.0	12.0	

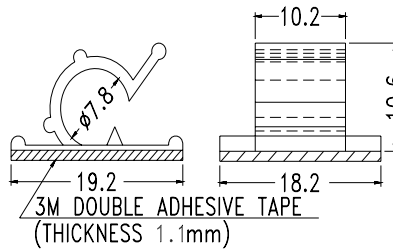
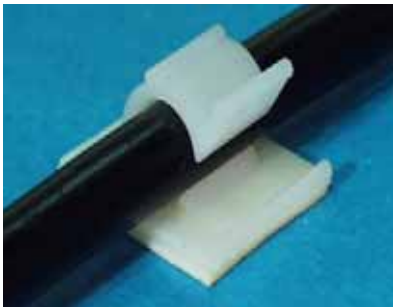

PART NO	PACKAGE
WC-1	500

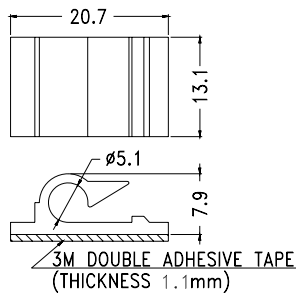
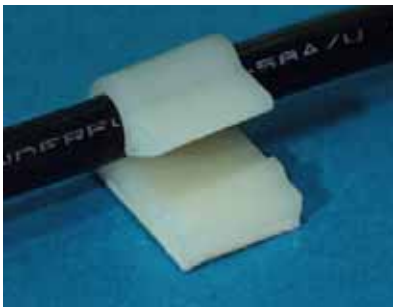

PART NO	PACKAGE
WCL-1	500

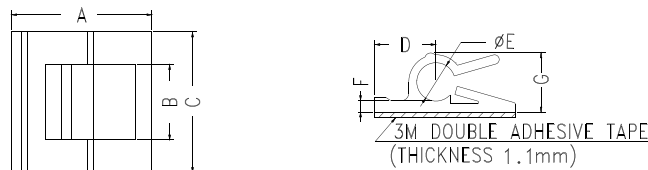

PART NO	A	B	C	D	E	F	G	PACKAGE
WCT-4	15.9	9.7	15.9	8.0	4.0	1.5	5.7	500
WCT-5	19.0	10.2	19.0	8.3	5.2	1.55	8.0	
WCT-6	19.0	10.0	20.0	8.0	6.0	1.1	9.9	

- ◆ MATERIAL: NYLON 66(UL)
- ◆ FLAME CLASS :94V-2
- ◆ COLOR: NATURAL
- ◆ UNIT: mm

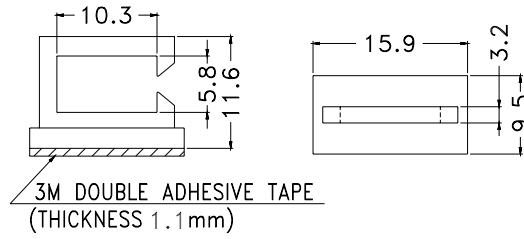
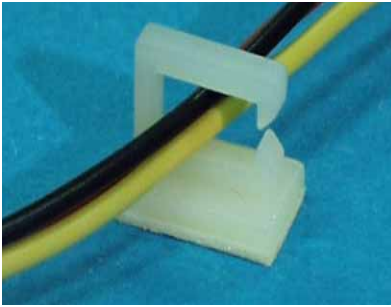

PART NO	PACKAGE
WSS-1	1000

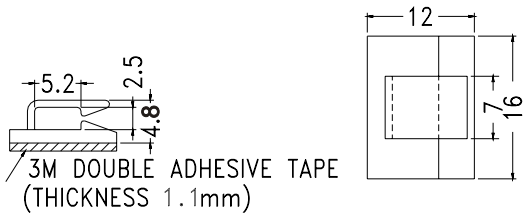
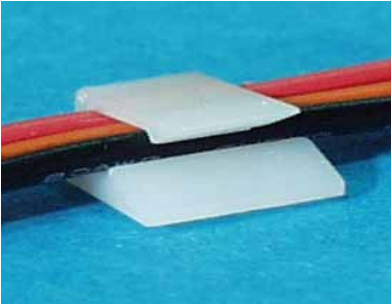

PART NO	PACKAGE
WC-4	1000

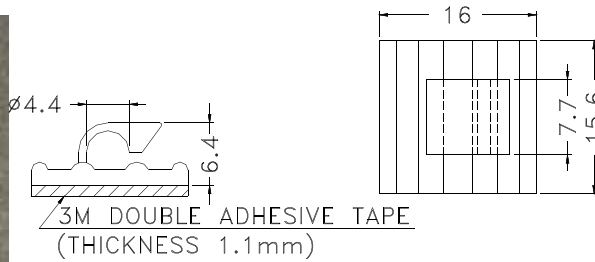

PART NO	PACKAGE
WC-5	1000

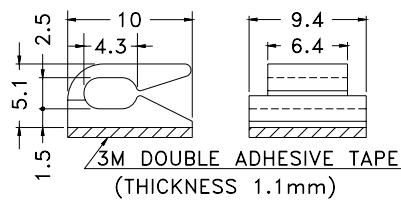
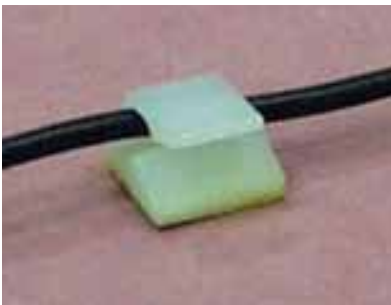

PART NO	PACKAGE
WC-6	1000

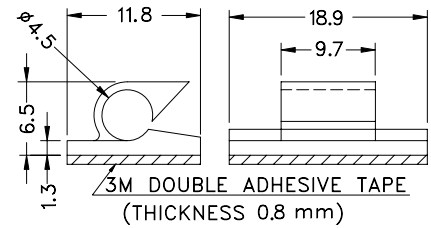

PART NO	PACKAGE
WCL-11	1000

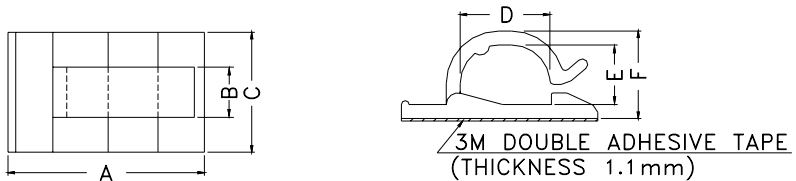

PART NO	A	B	C	D	E	F	PACKAGE
WCL-8	25.4	6.5	15.5	11.6	7.8	11.3	500
WCL-9	25.2	12.7	25.2		7.6	11.0	

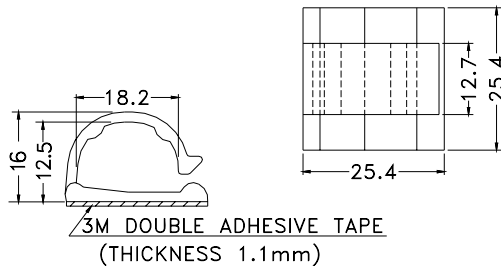
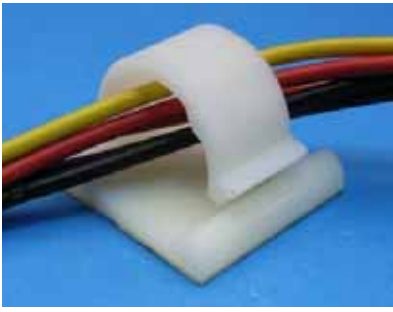

- ◆ MATERIAL: NYLON 66(UL)
- ◆ FLAME CLASS :94V-2
- ◆ COLOR: NATURAL
- ◆ UNIT: mm

PART NO	PACKAGE
WCL-10	500

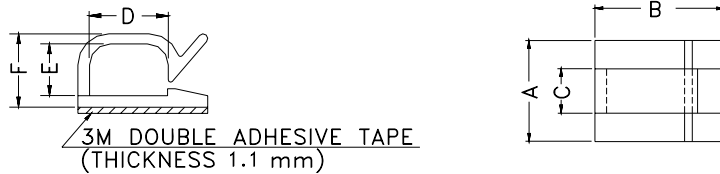
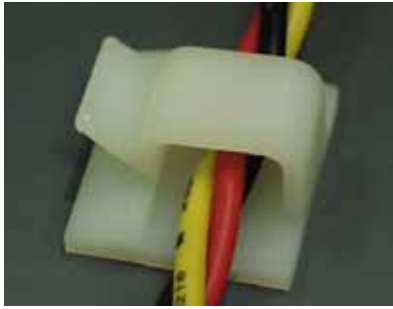

PART NO	A	B	C	D	E	F	PACKAGE
WCL-4	16.0	14.4	7.1	8.2	5.2	8.0	1000
WCL-5	16.0	16.8	7.0	10.2	6.7	9.5	500
WCL-6	19.0	19.0	9.7	12.5	8.1	11.0	
WCL-7	19.0	20.8	9.0	13.6	8.2	11.3	

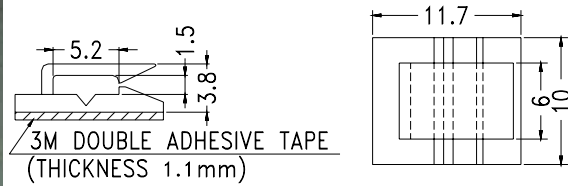
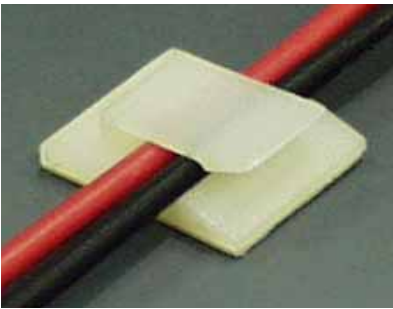

PART NO	PACKAGE
WCLA-1	1000

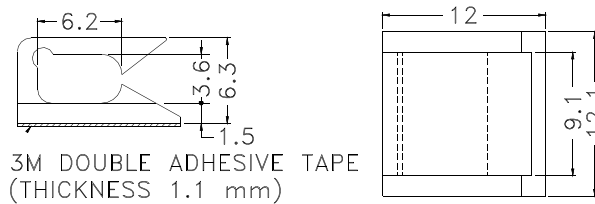
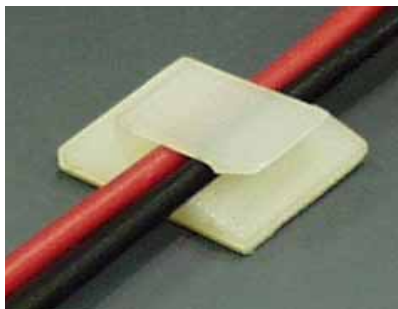

PART NO	PACKAGE
WSB-1	1000

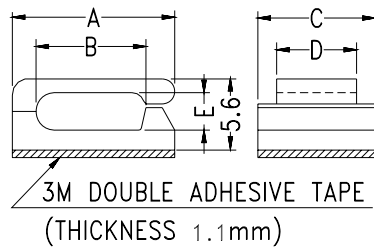

PART NO	A	B	C	D	E	PACKAGE
MWS-2	13.0	8.5	9.2	6.3	3.0	1000
MWS-3	16.0	11.5	13.0	9.0	2.9	

- ◆ MATERIAL: NYLON 66(UL)
- ◆ FLAME CLASS : 94V-2
- ◆ COLOR: NATURAL
- ◆ UNIT: mm

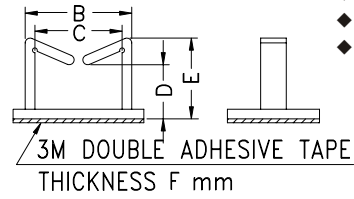
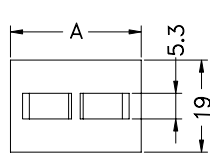
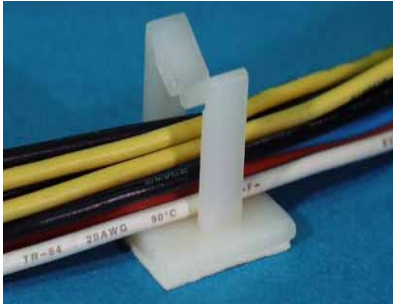

PART NO	A	B	C	D	E	F	PACKAGE
WT-1	21.0	15.5	11.5	10.0	17.2	1.1	500
★ WT-3	27.0	22.0	18.0	11.2	16.7	0.8	

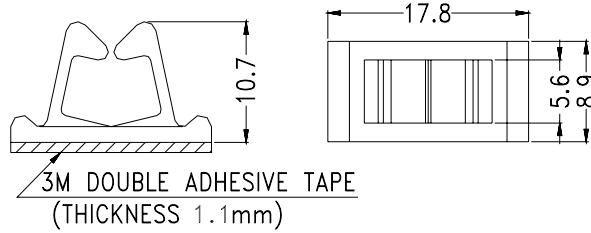
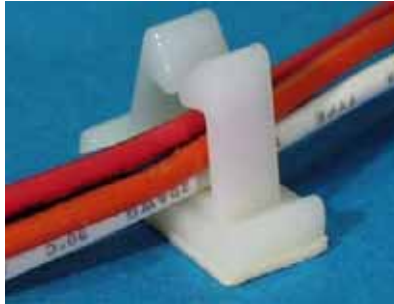

PART NO	PACKAGE
WT-2	1000

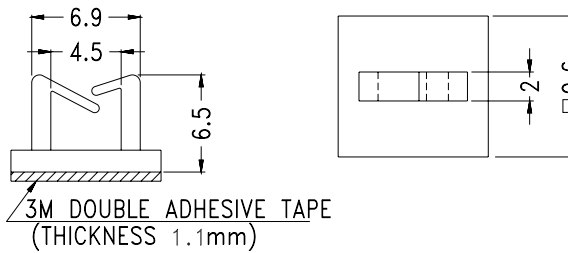
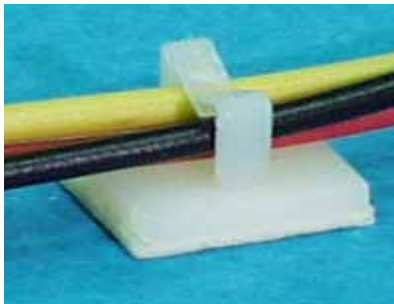

PART NO	PACKAGE
WLL-1	1000

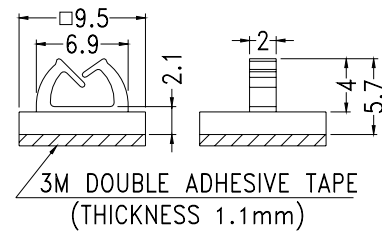
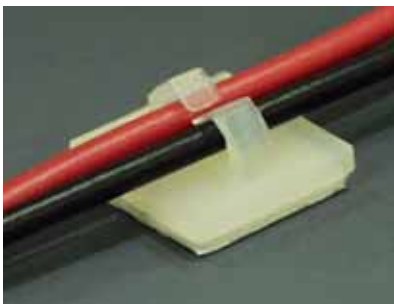

PART NO	PACKAGE
WLL-2	1000

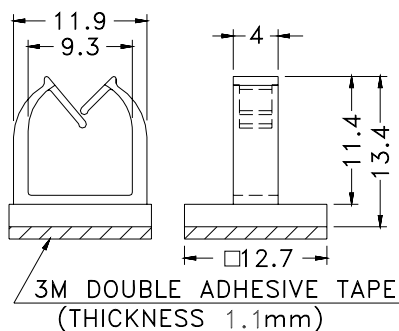

PART NO	PACKAGE
WLL-3	1000

- ◆ MATERIAL: NYLON 66(UL)
- ◆ FLAME CLASS :94V-2
- ◆ COLOR: NATURAL
- ◆ UNIT: mm

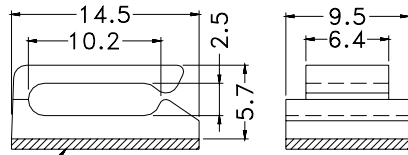

3M DOUBLE ADHESIVE TAPE  
(THICKNESS 1.1mm)

PART NO	PACKAGE
MWS-2D	1000

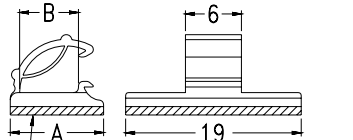

3M DOUBLE ADHESIVE TAPE  
(THICKNESS 1.1mm)

PART NO	A	B	PACKAGE
WCC-1	10.0	6.3	1000
WCC-2	14.0	10.5	500

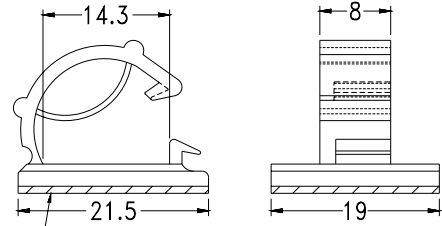

3M DOUBLE ADHESIVE TAPE  
(THICKNESS 1.1mm)

PART NO	PACKAGE
WCC-3	500

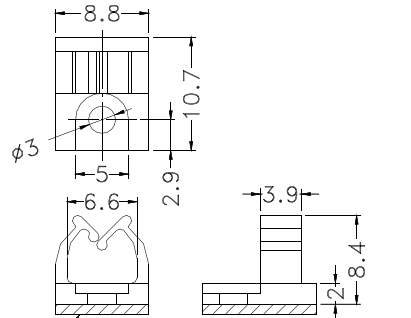

3M DOUBLE ADHESIVE TAPE  
(THICKNESS 1.1mm)

PART NO	PACKAGE
MWS-9	2000

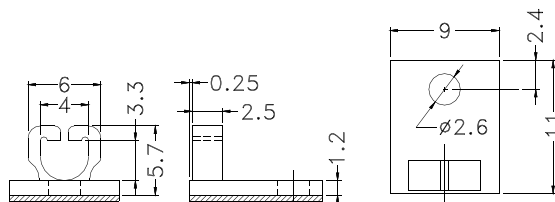
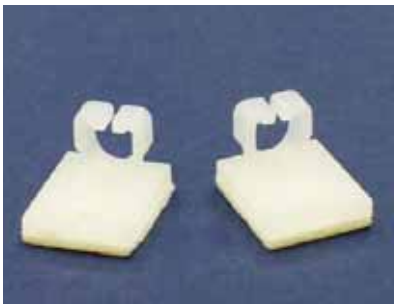

3M DOUBLE ADHESIVE TAPE  
(THICKNESS 1.1mm)

PART NO	PACKAGE
IMN-1	1000

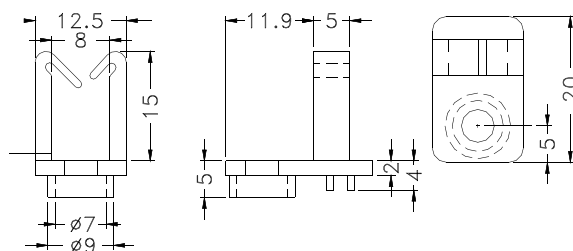

PART NO	PACKAGE
CHU-1	1000